

ZONING DISPLAY MAP

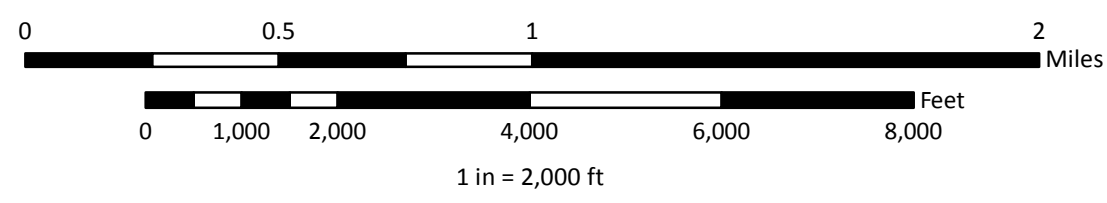
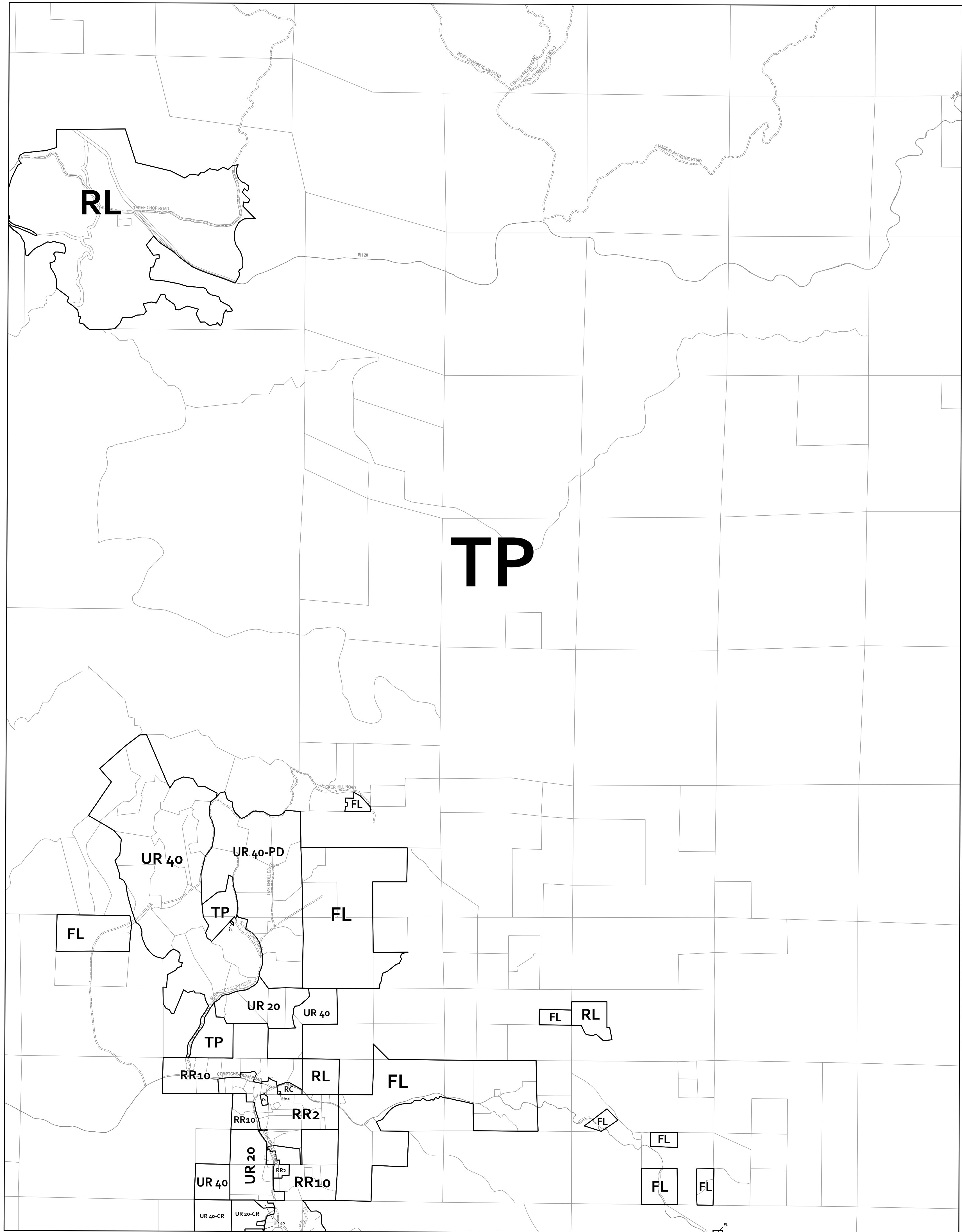

ABBREVIATION KEY

AG : Agricultural	I1:CR : Inland Limited Industrial (Contract Rezone)	UR:CR : Upland Residential (Contract Rezone)	MC : Mendocino Commercial
AG:CR : Agricultural (Contract Rezone)	I2 : Inland General Industrial	UR:PD : Upland Residential (Planned Development)	MFL : Mendocino Forestland
AZ : Airport Zone	OS : Open Space	R1 : Single Family Residential	MMU : Mendocino Mixed-Use
C : Coastal Commercial	OS:CR : Open Space (Contract Rezone)	R2 : Two Family Residential	MOS : Mendocino Open Space
C-PD : Coastal Commercial (Planned Development)	PI : Pinoleville Industrial	R3 : Multi Family Residential	MPF : Mendocino Public Facility
C1 : Inland Limited Commercial	PF : Public Facility	RMR : Remote Residential	MRM : Mendocino Multi-Family Residential
C1:CR : Inland Limited Commercial (Contract Rezone)	PF:PD : Public Facility (Planned Development)	RMR:DL : Remote Residential (Development Limitation)	MRR : Mendocino Rural Residential
C2 : Inland General Commercial	RC : Rural Community	RMR:PD : Remote Residential (Planned Development)	MSR : Mendocino Suburban Residential
C2:CR : Inland General Commercial (Contract Rezone)	RC:CR : Rural Community (Contract Rezone)	RR : Rural Residential	MTR : Mendocino Town Residential
C2:IS : Inland General Commercial (Isolated Service)	RL : Rangeland	RR:CR : Rural Residential (Contract Rezone)	GPD : Gualala Planned Development
FL : Forestland	RL:PD : Rangeland (Planned Development)	RR:DL : Rural Residential (Development Limitation)	GVMU : Gualala Village Mixed Use
FV : Fishing Village	SR : Suburban Residential	RR:PD : Rural Residential (Planned Development)	GHMU : Gualala Highway Mixed Use
I : Coastal Industrial	TP : Timberland Production	RR:PD-DL : Rural Residential (Planned Development Limitation)	GI : Gualala Industrial
I1 : Inland Limited Industrial	UR : Upland Residential	RV : Rural Village	RR_[RR_]_ : Variable Density Zone (see note below)

COMPTCHE USGS QUADRANGLE BASE

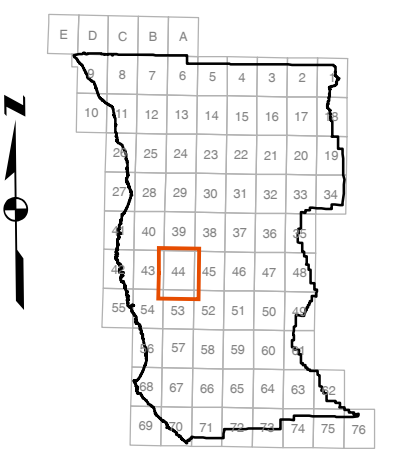

ZONING DISPLAY MAP



PRODUCED 2019
MENDOCINO COUNTY
PLANNING & BLDG. SVCS.

THIS IS NOT AN ADOPTED MAP
FOR DISPLAY PURPOSES ONLY

Print Date: 11/19/2019

Zoning designations shown in [brackets] (coastal zone only) indicate 'variable density zones'. Per county code Sec. 3.8-10 in order to be developed to the smaller parcel size, areas indicated on the map as having a variable density zoning classification shall be required to be served by a public water system which utilizes surface waters, and which does not impact upon the ground water resource, or by completion of a hydrological study which supports those greater densities.